

## mode d'emploi

### fixation

- scellement chimique.
- collage sans perçage.

fixation par perçage en option  
tige M5 16mm / 30mm sur demande

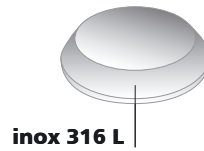
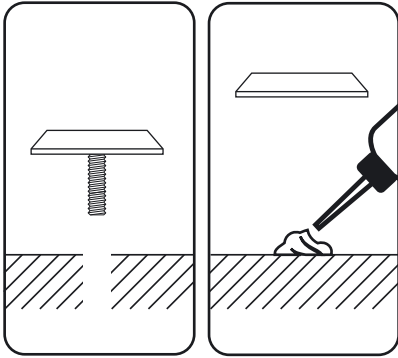

## fiche technique podotone bouton in 25 Ø25mm

## plans

### vue de dessus

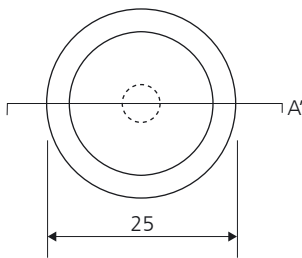

### vue de profil

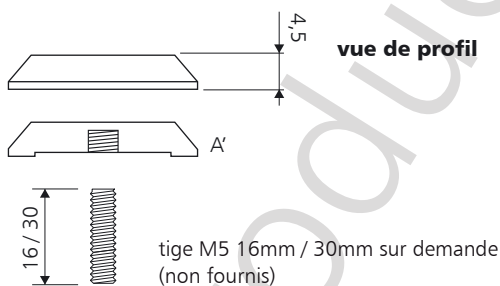

### vue de dessous

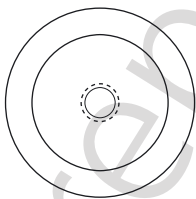

## finitions

standards  
inox 316 L